



# ECLIPSE II™

3,0 x 4,5m (10'x15')

# PRICE LIST

## PROFESSIONAL PRODUCTS - Spare Parts

# 2009

**EC2HSF1015W - High Strength Steel**  
White, Frame Weight; 38 kg.

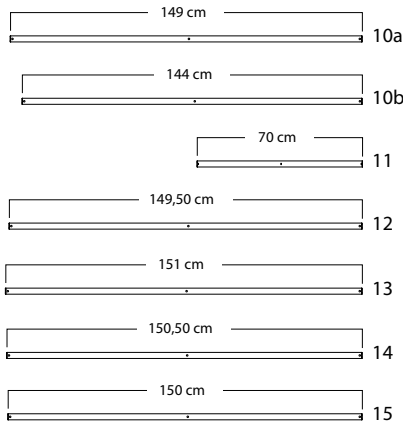
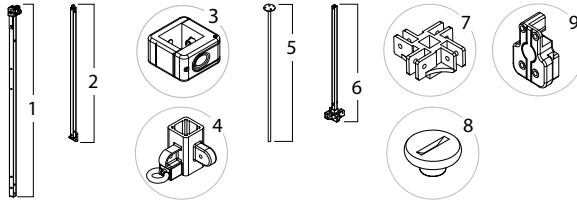

Item Number	Anzahl	Preis pro Stk.
(1) - EC2HSPOL62TGW (outer leg, white)	X	€ 23,30
(2) - EC2HSPIL40TW (inner leg, white)	X	€ 15,00
(3) - EC2HSPPTGW (toggle, white)	X	€ 5,80
(4) - EC2HSPSLPPW (slider, pull-pin, white)	X	€ 5,80
(5) - EC2HSPPPW (peak pole, white)	X	€ 5,20
(6) - EC2HSPPBW (peak beam, white)	X	€ 21,50
(7) - EC2HSPPSW (peak slider, white)	X	€ 4,70
(8) - EC2PTAN2303 (top attachment nut)	X	€ 1,20
(9) - EC2HSPBP15W (pivot bracket, white)	X	€ 5,50
(10a) - EC2HSPTR2239W (inner truss, white - 149 cm)	X	€ 11,00
(10b) - EC2HSPTR2238W (inner truss, white - 144 cm)	X	€ 9,00
(11) - EC2HSPTR2293W (middle truss, white - 70 cm)	X	€ 7,00
(12) - EC2HSPTR3811W (outer truss, white - 149,50cm)	X	€ 12,50
(13) - EC2HSPTR2572W (middle outer truss, white - 151 cm)	X	€ 11,50
(14) - EC2HSPTR3810W (inner truss, white - 150,50 cm)	X	€ 12,00
(15) - EC2HSPTR2240W (outer truss, white - 150 cm)	X	€ 11,50
EC2HSPNBK (nuts and bolts kit, white (not shown))	X	€ 16,30
CBPR15BK (cover bag, black (not shown))	X	€ 33,80

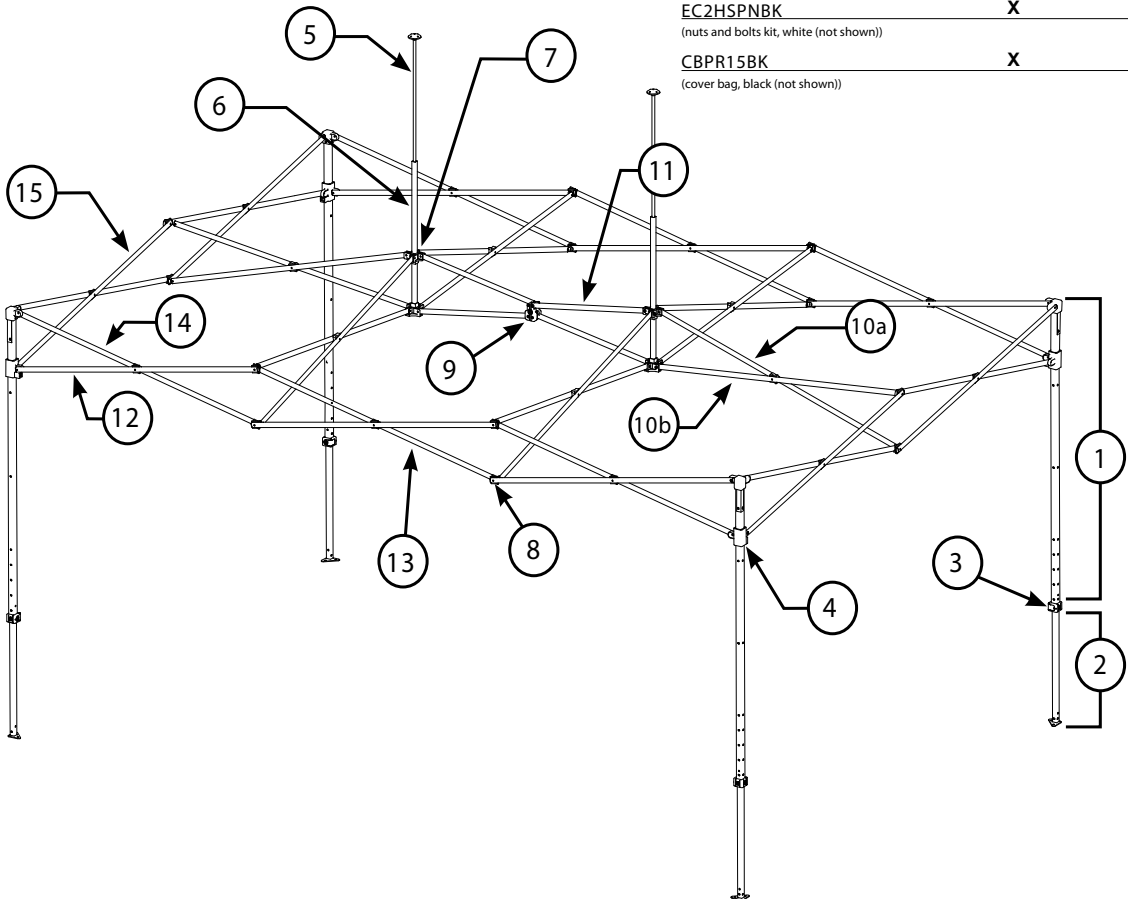



# ECLIPSE™ II

3,0 x 4,5m (10'x15')

# PRICE LIST

## PROFESSIONAL PRODUCTS - Spare Parts

# 2009

### EC2ALF1015C - Aircraft Aluminum Aluminum, Frame Weight; 30 kg.

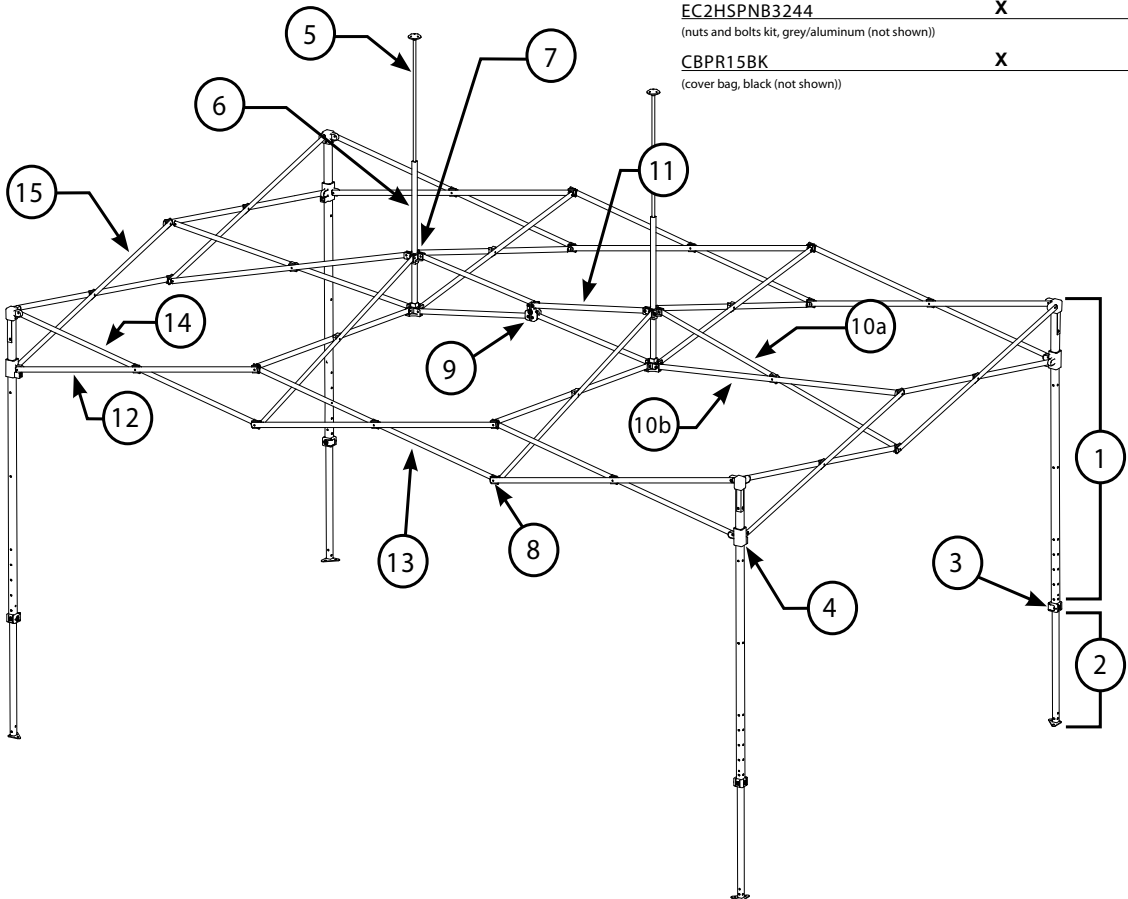
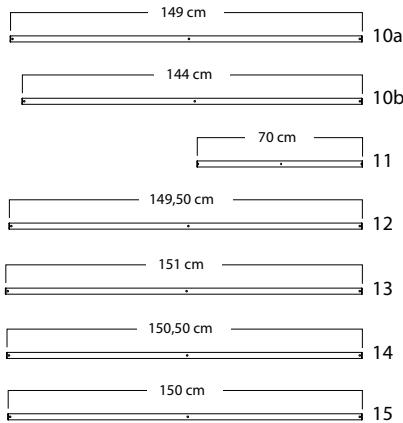
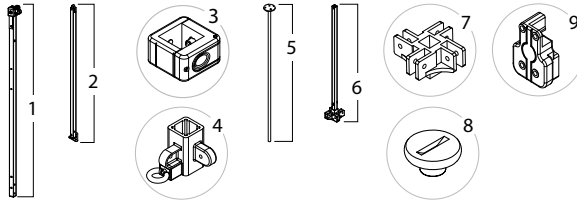

Item Number	Anzahl	Preis pro Stk.
(1) - EC2ALPOL62TGC (outer leg, aluminum)	X	€ 31,90
(2) - EC2ALPIL40TC (inner leg, aluminum)	X	€ 16,80
(3) - EC2ALPTGG (toggle, grey)	X	€ 5,80
(4) - EC2ALPSLPPG (slider, pull-pin, grey)	X	€ 5,80
(5) - EC2ALPPPC (peak pole, aluminum)	X	€ 5,20
(6) - EC2ALPPBC (peak beam, aluminum)	X	€ 21,50
(7) - EC2ALPPSG (peak slider, grey)	X	€ 4,70
(8) - EC2PTAN2303 (top attachment nut)	X	€ 1,20
(9) - EC2ALPP15G (pivot bracket, grey)	X	€ 6,40
(10a) - EC2ALPTR2406CL (inner truss, aluminum - 149 cm)	X	€ 11,60
(10b) - EC2ALPTR2407CL (inner truss, aluminum - 144 cm)	X	€ 12,80
(11) - EC2ALPTR2740CL (middle truss, aluminum - 70 cm)	X	€ 8,70
(12) - EC2ALPTR3579CL (outer truss, aluminum - 149,50cm)	X	€ 14,50
(13) - EC2ALPTR2207CL (middle outer truss, aluminum - 151 cm)	X	€ 15,10
(14) - EC2ALPTR3581CL (inner truss, aluminum - 150,50 cm)	X	€ 14,50
(15) - EC2ALPTR2405CL (outer truss, aluminum - 150 cm)	X	€ 14,50
EC2HSPNB3244 (nuts and bolts kit, grey/aluminum (not shown))	X	€ 16,30
CBPR15BK (cover bag, black (not shown))	X	€ 31,30

# ADRESSFORMULAR



Name

Anschrift

Telefon

Fax

E-Mail

Kaufdatum

Ausführung    Verzinkt     Aluminium     Weiß pulverbeschichtet

Bemerkung

Senden Sie diese Formulare via Fax an:  
**02324 707401**